

现状图

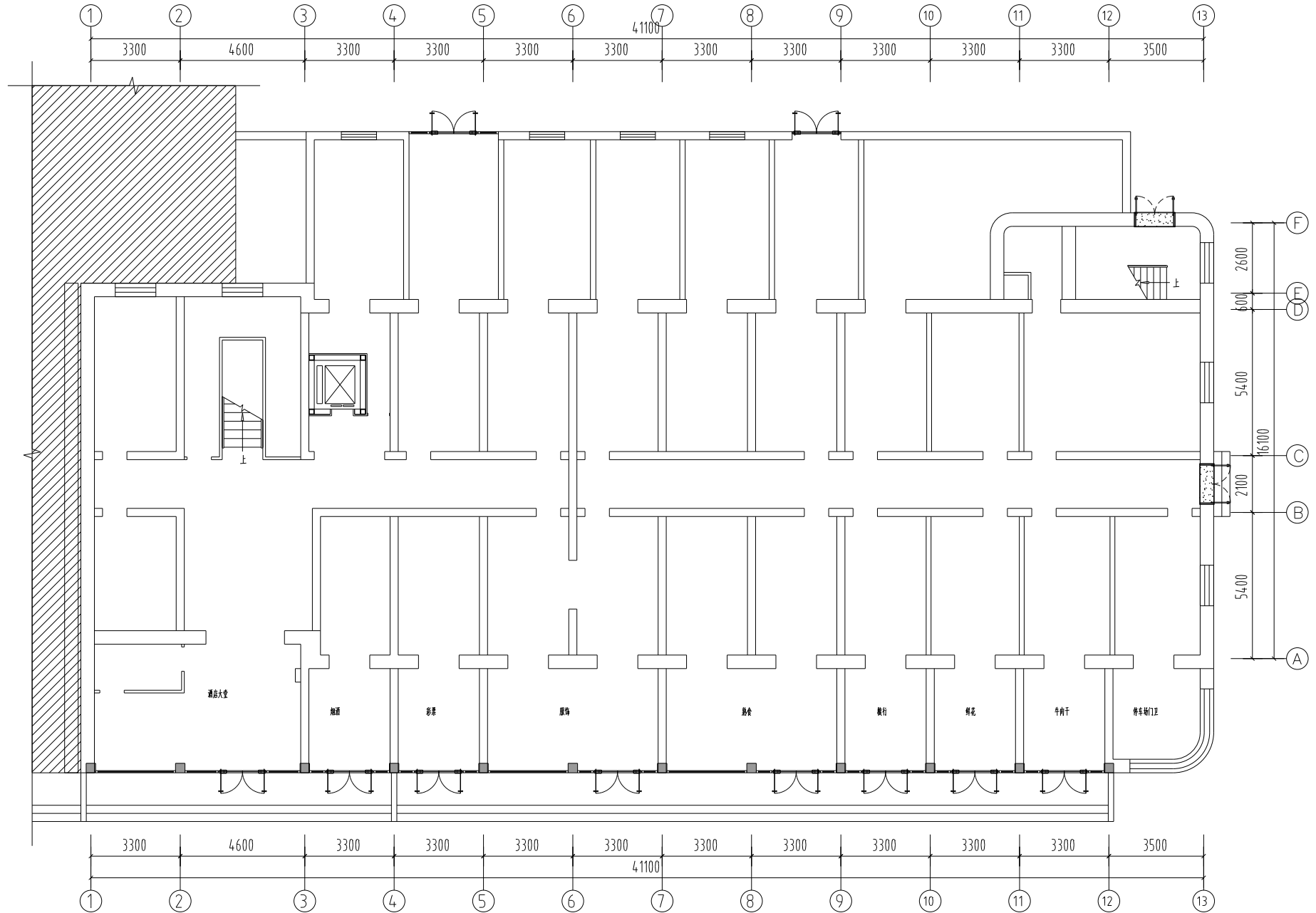

板下3500,梁下3000(涉及到同层排水,同层排水高度270,整体拆除)

客房吊顶2800,走廊吊顶2400

窗高2050,窗台高770

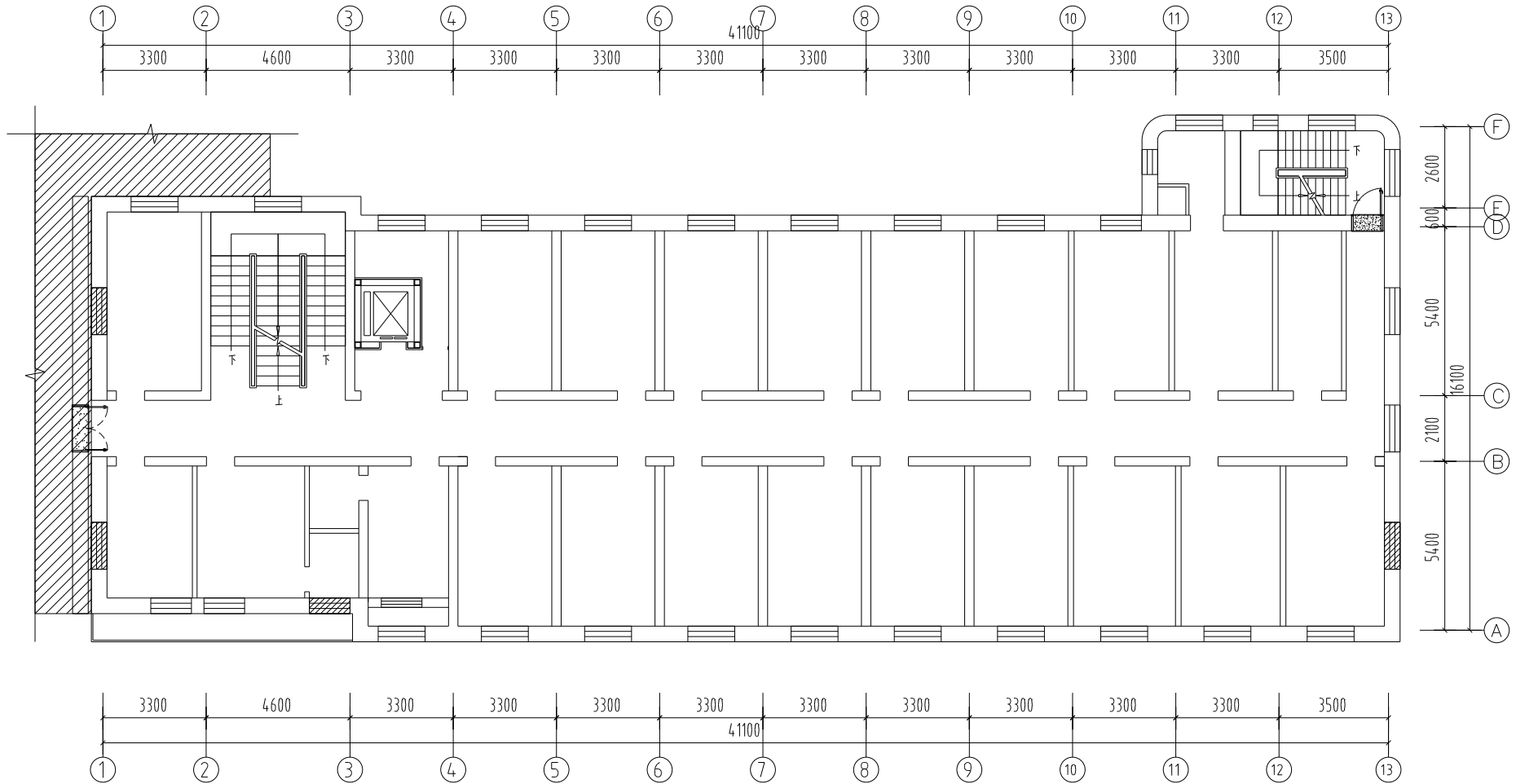

板下3500,梁下3000

客房吊顶2800,走廊吊顶2400

窗高2050,窗台高770

板  
客  
窗

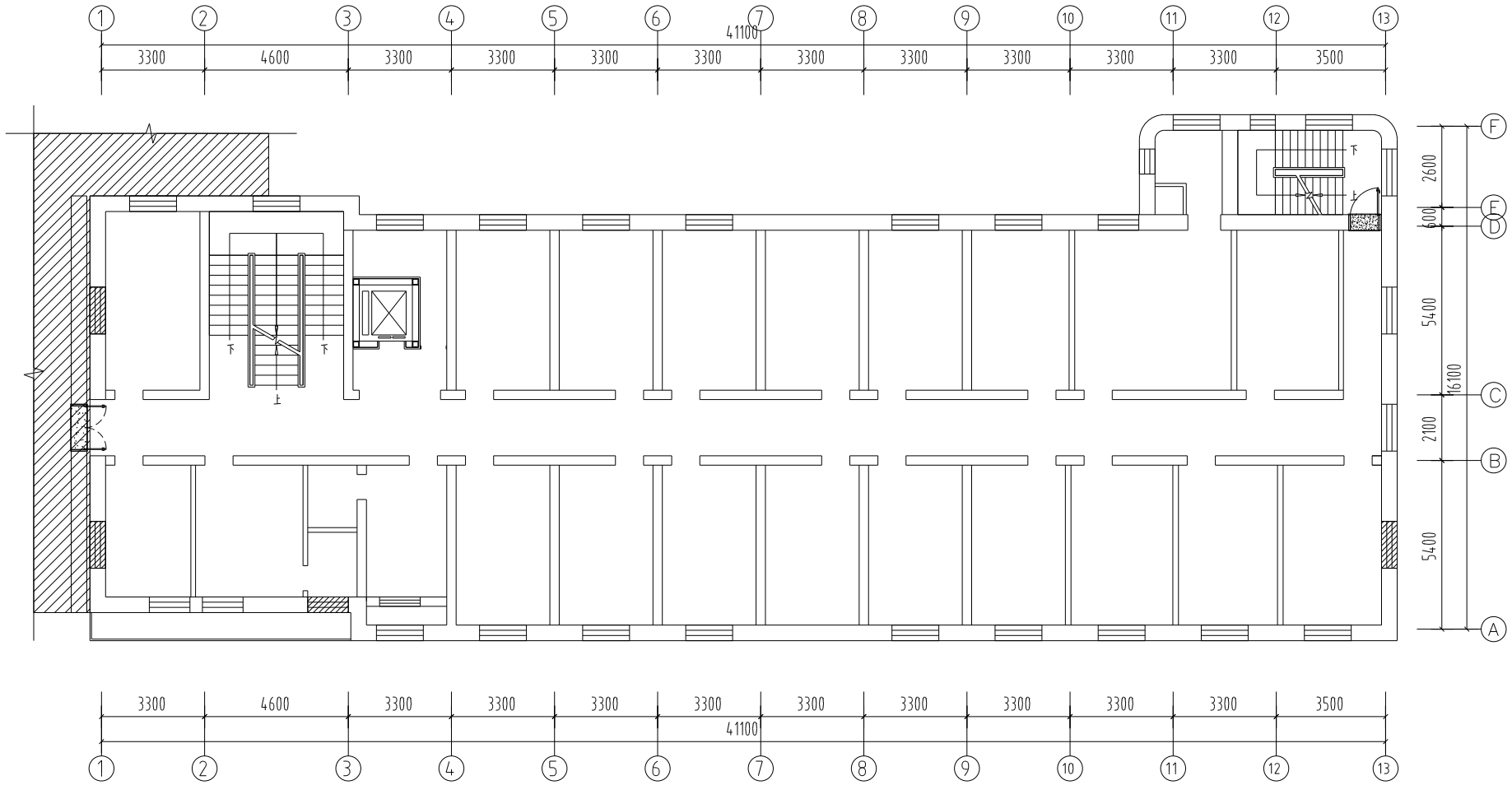

三层

1:100

板下3500,梁下3000

客房吊顶2800,走廊吊顶2400

窗高2050,窗台高770

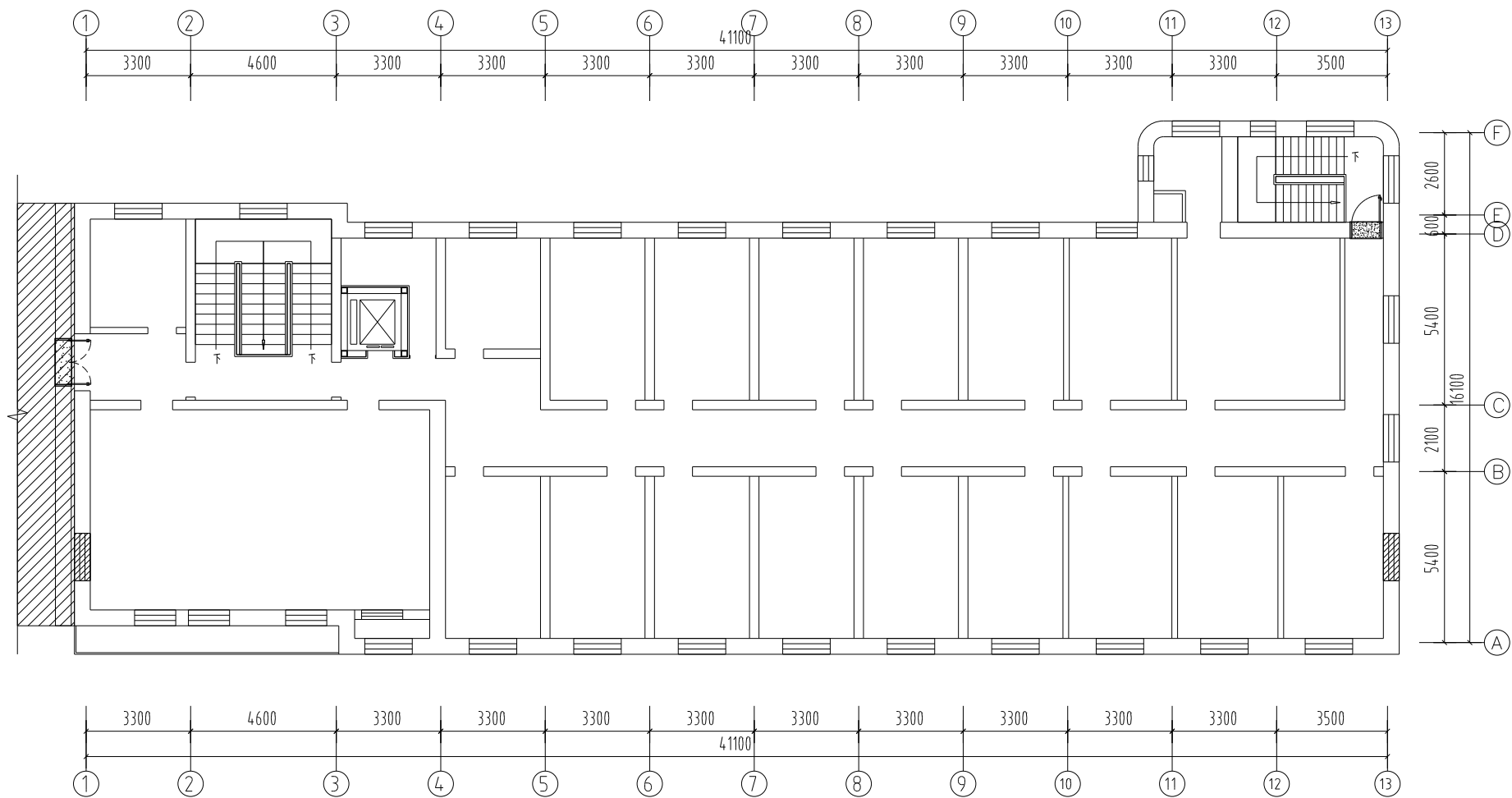

排房图

